

SUPERMARINE WALRUS

BY TREVOR HEWSON AND MIKE ROACH
SHEET 2 OF 2
ALL MATERIALS 3mm DEPRON UNLESS STATED

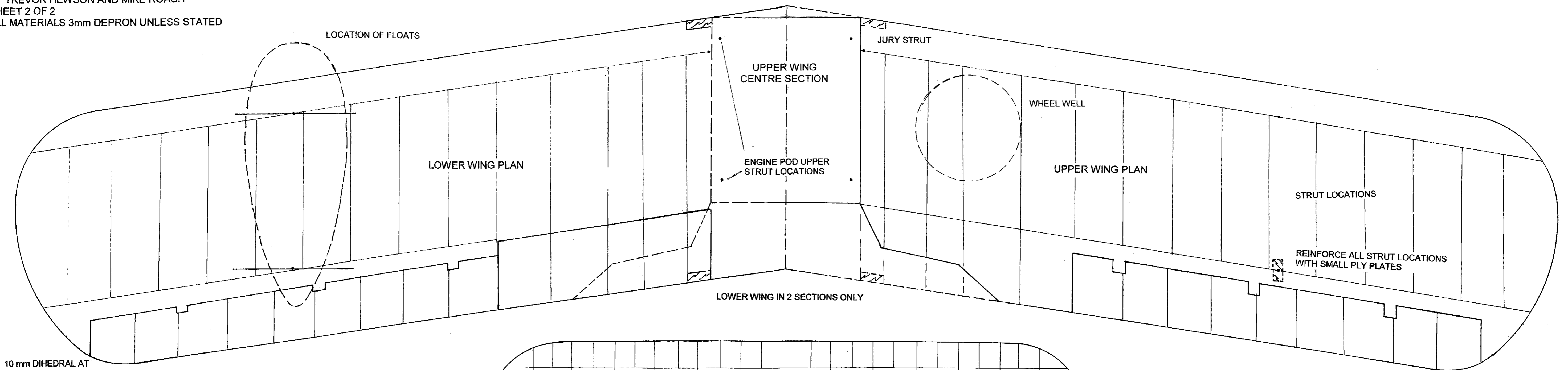

10 mm DIHEDRAL AT UPPER WING TIPS.
25 mm AT LOWER WING TIPS

TAILPLANE: NOTE CUT-OUT

UC LEGS GLUED TO 0.8 PLY JOINT WHICH IS GLUED TO AXLE. DO NOT GLUE LEGS TO FUSELAGE

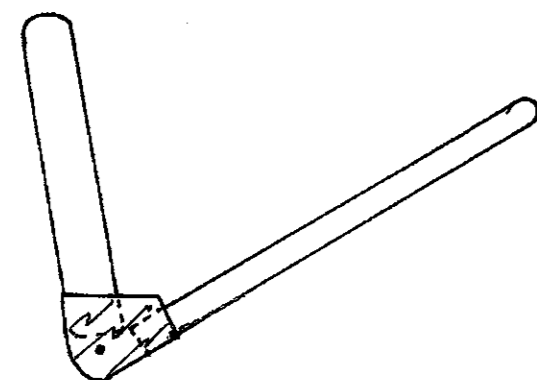

ELEVATORS: HINGE WITH TAPE ON UNDERSIDE

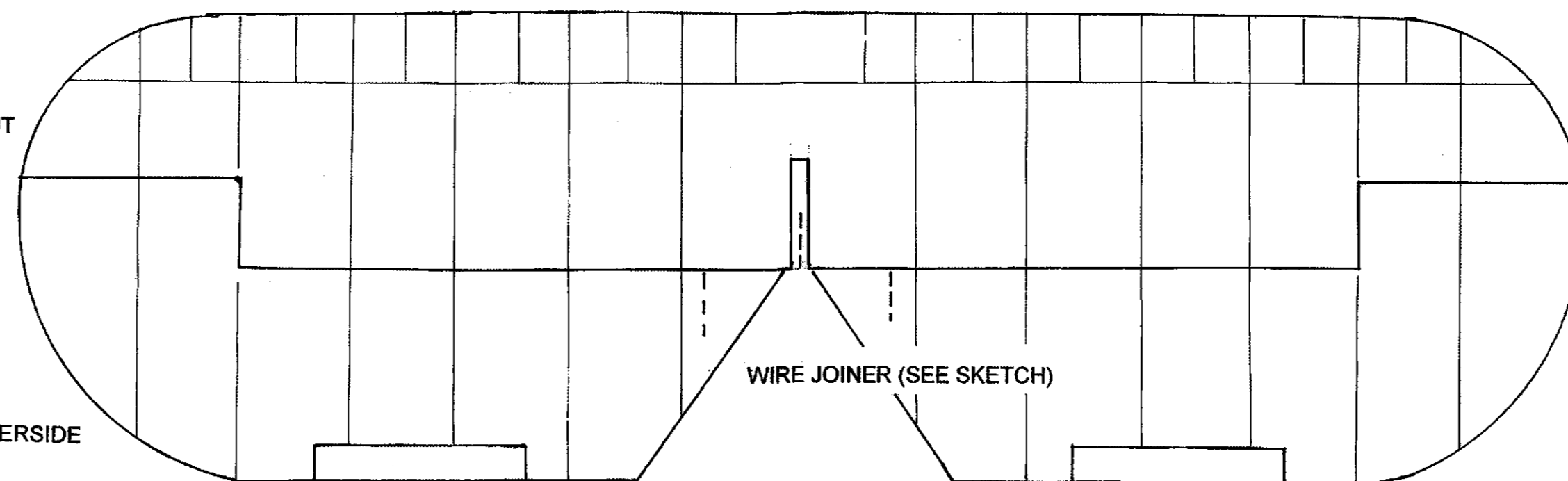

SKETCH OF ELEVATOR FUNCTION

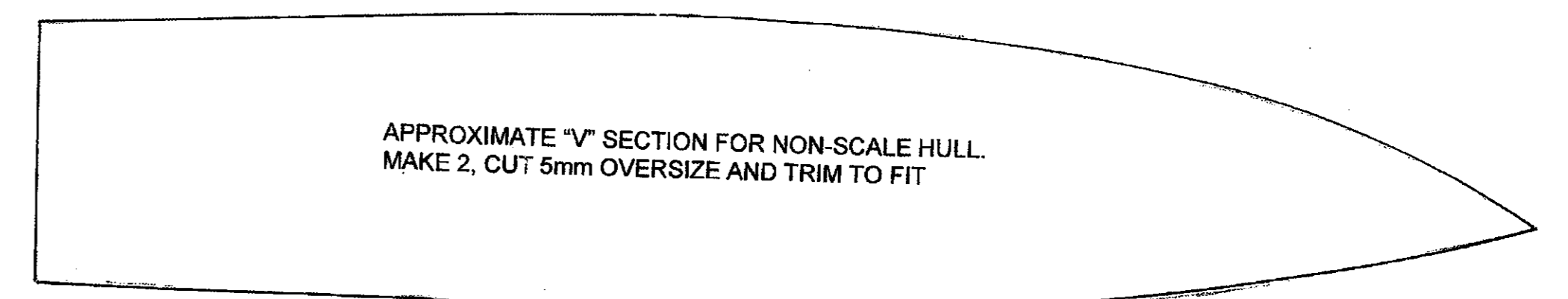
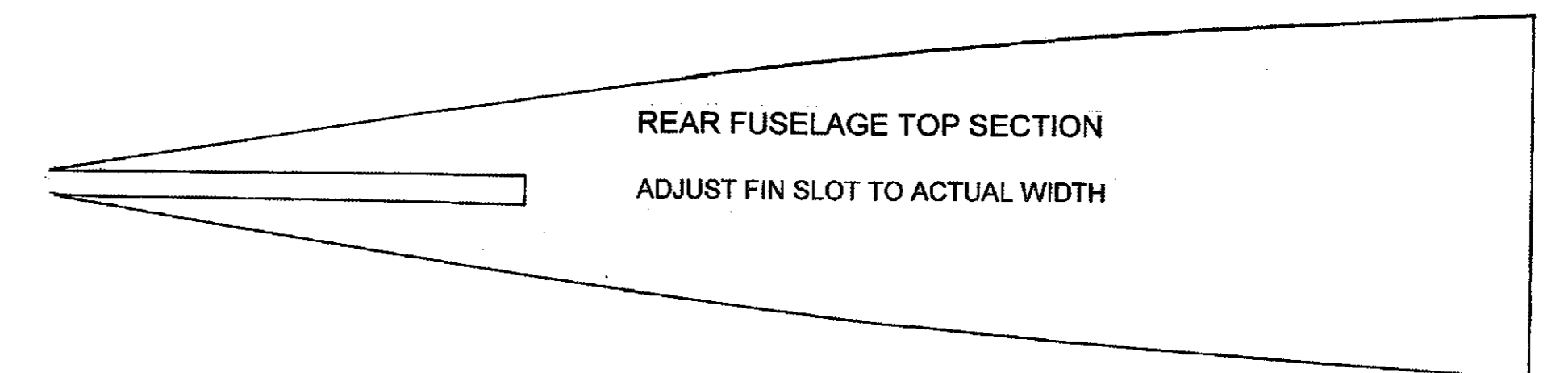
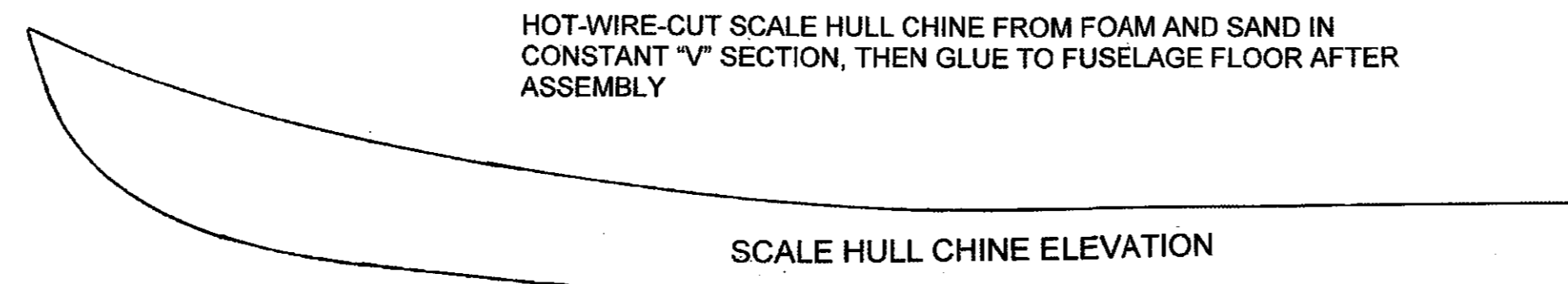
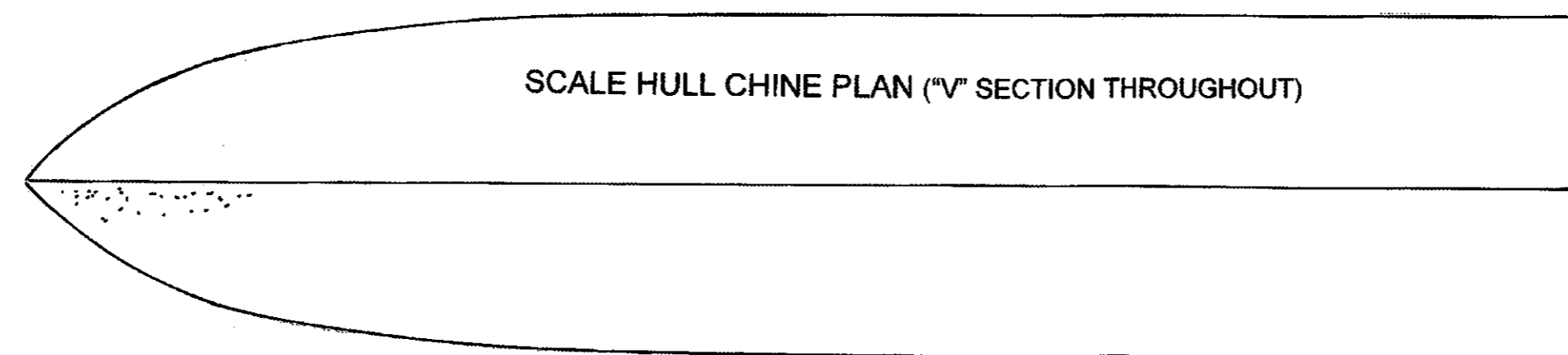
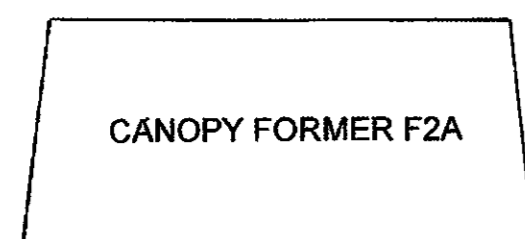
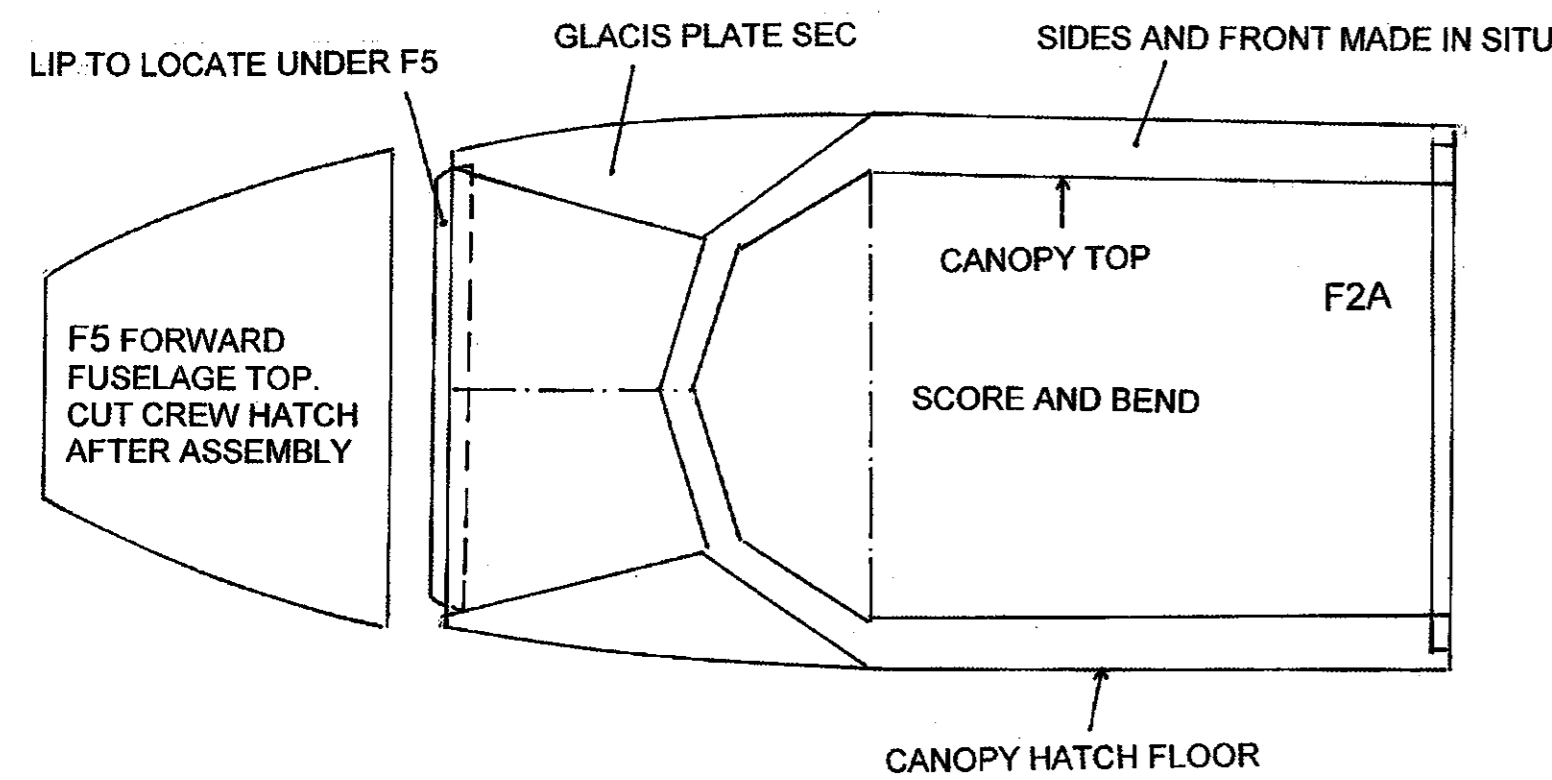
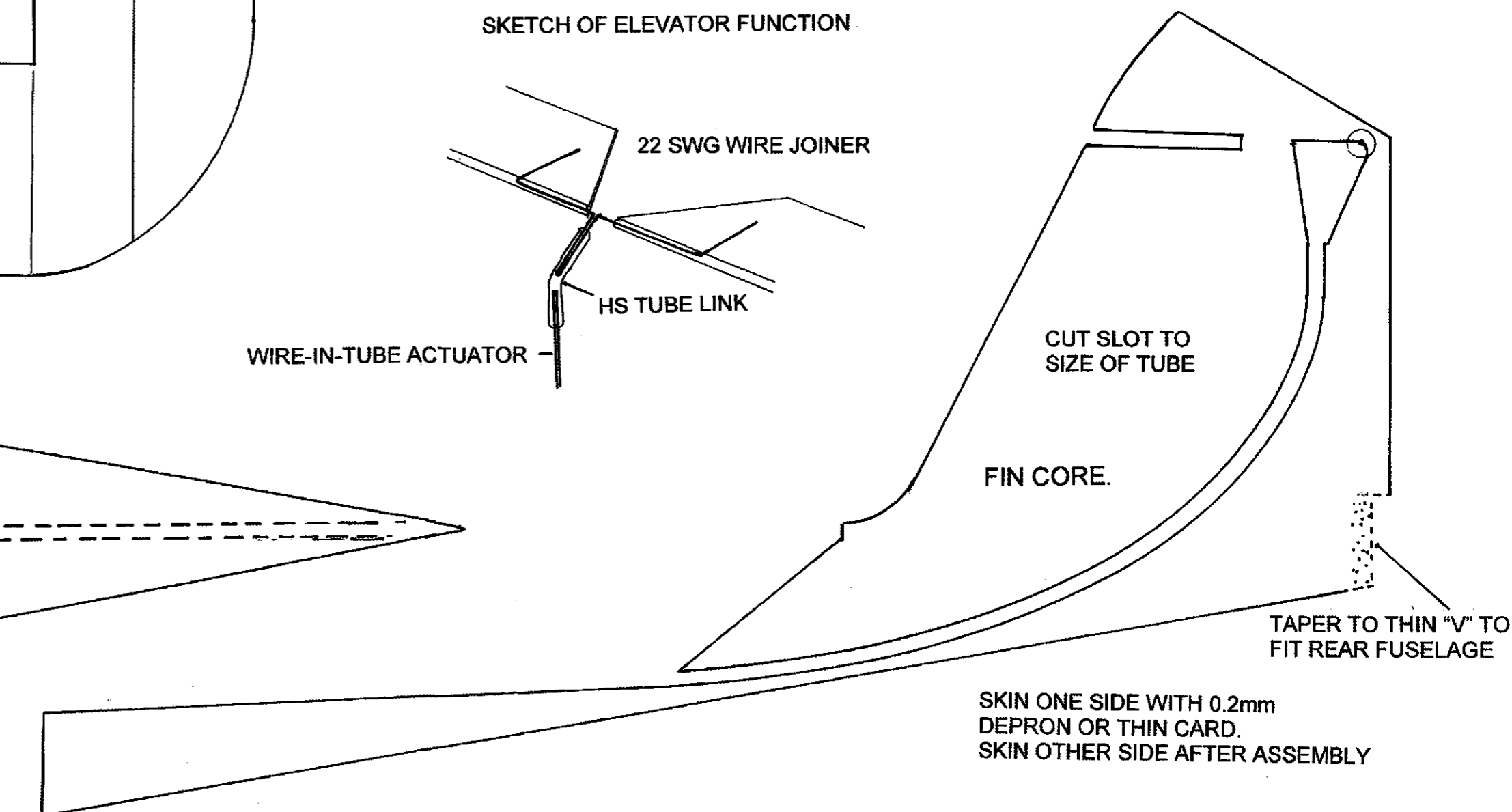
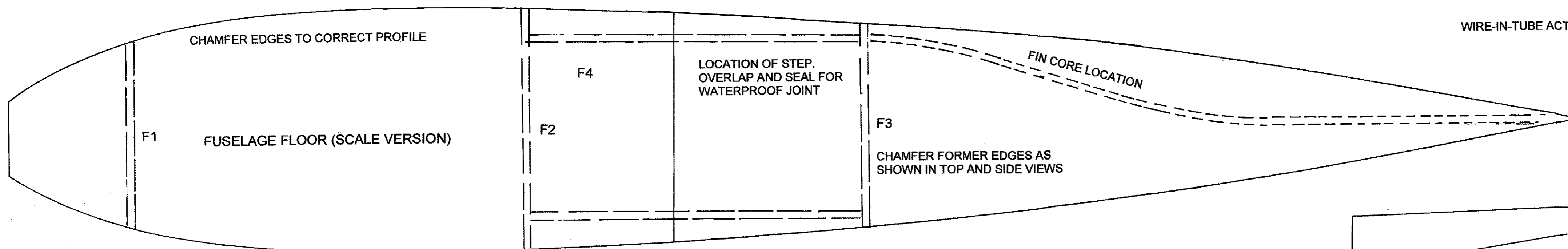
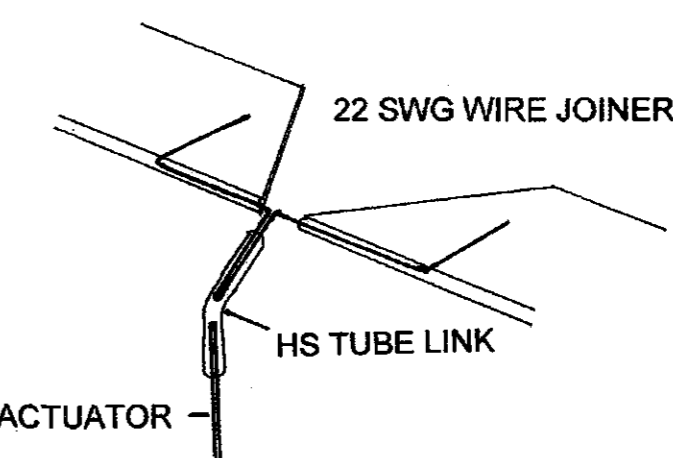

ELEVATION AT F2, SHOWING FRONT ENGINE POD STRUTS

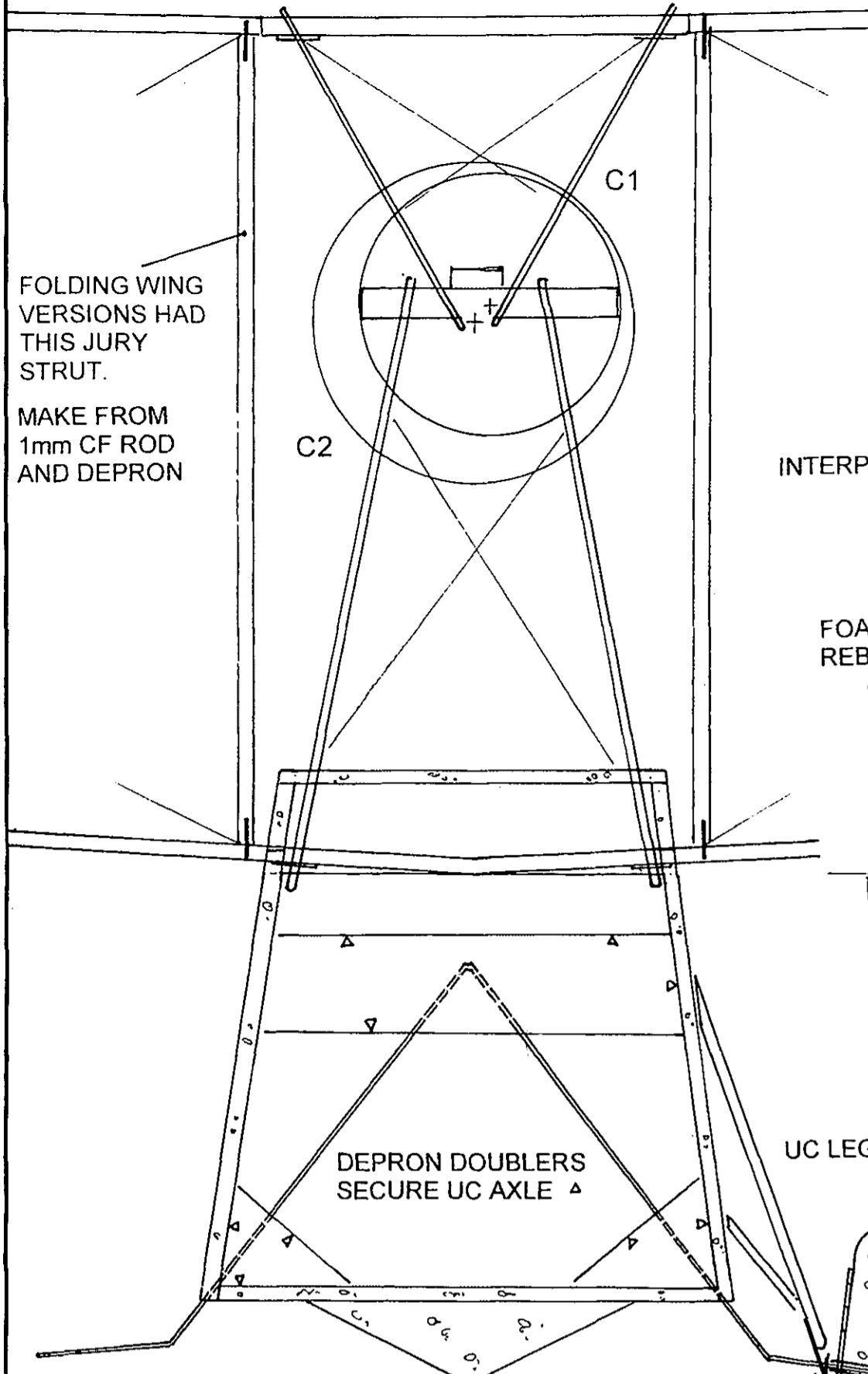

FOLDING WING VERSIONS HAD THIS JURY STRUT. MAKE FROM 1mm CF ROD AND DEPRON

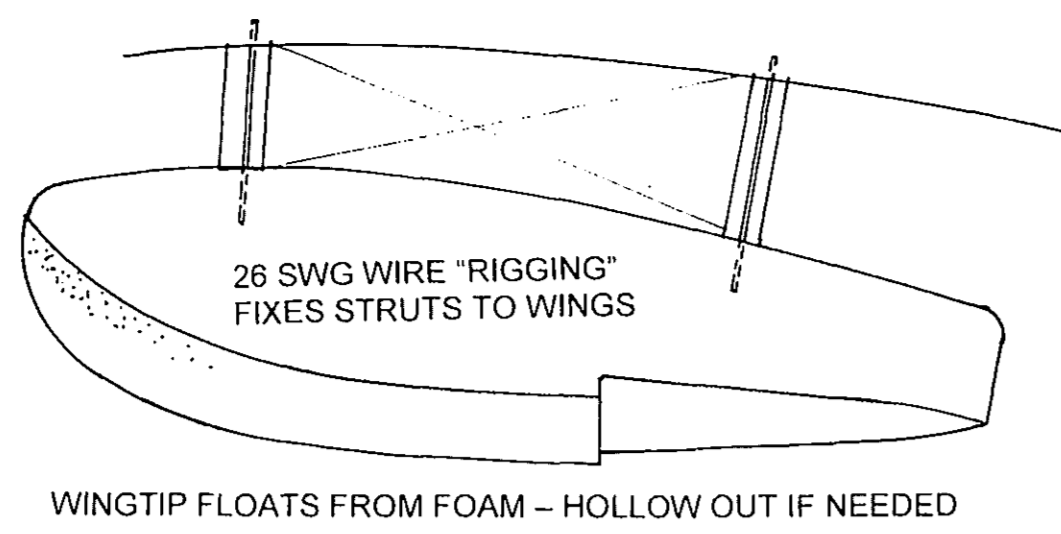

WINGTIP FLOATS FROM FOAM - HOLLOW OUT IF NEEDED

INTERPLANE RIGGING IS ESSENTIAL

FOAM NOSEBLOCK REBATE TO FIT

UC LEGS: DO NOT FIX TO FUSELAGE

FOAM WHEELS WITH 0.8 PLY REINFORCEMENT. BUSH WITH ALLOY TUBE

22 SWG WIRE AXLE

0.8 PLY UC LEG BEARER PLATE, FIXED TO AXLE

FOAM WHEEL COVERS

SECTION AT INTERPLANE STRUTS

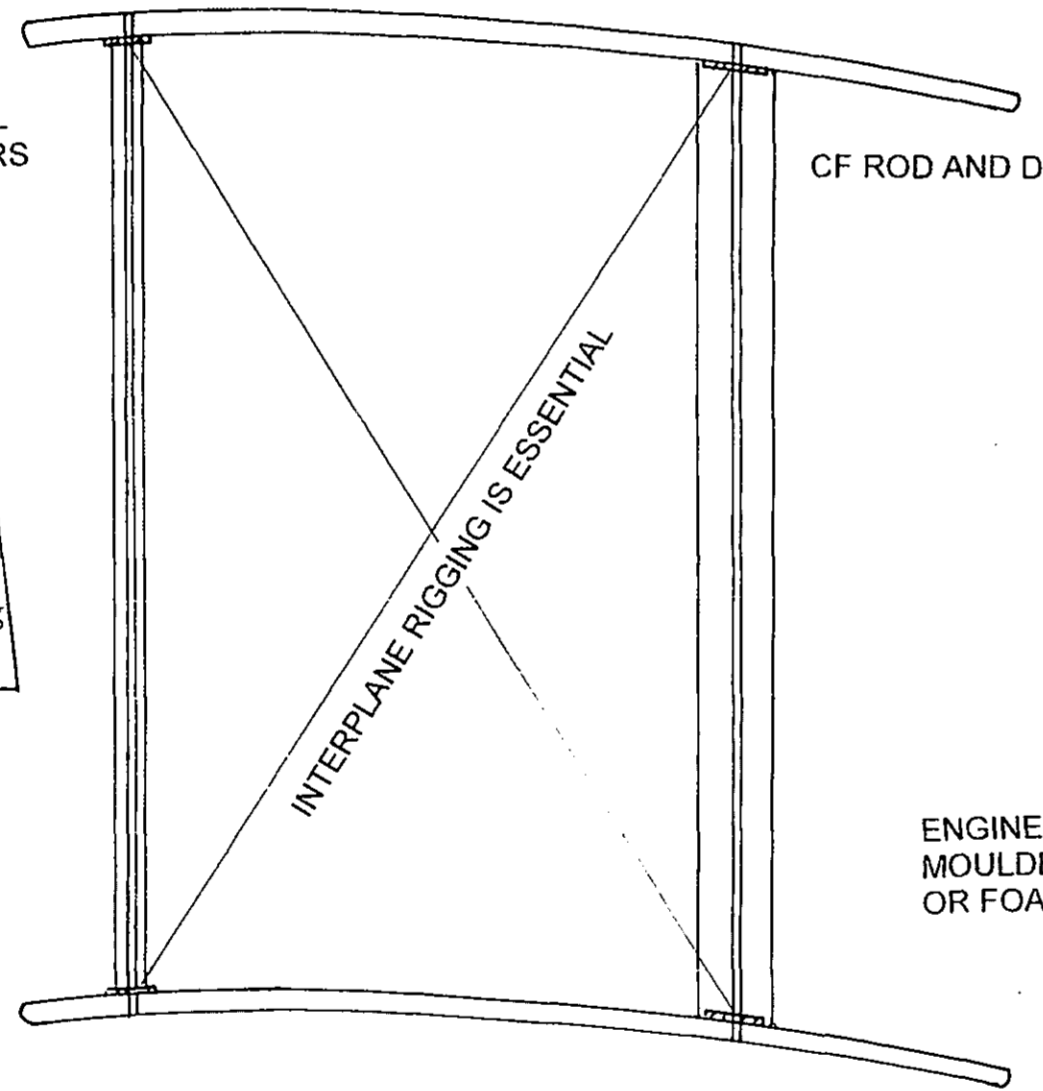

CF ROD AND DEPRON STRUTS

INTERPLANE RIGGING IS ESSENTIAL

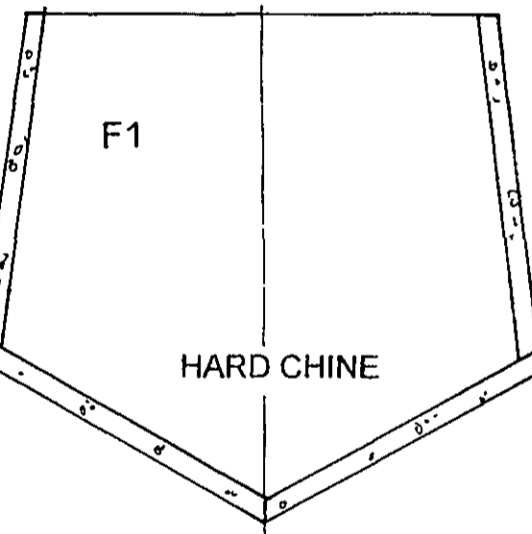

HARD CHINE

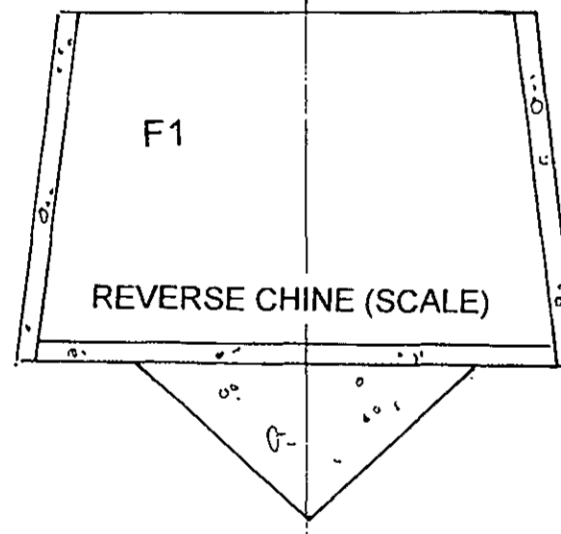

REVERSE CHINE (SCALE)

CHAMFER EDGES AS REQUIRED

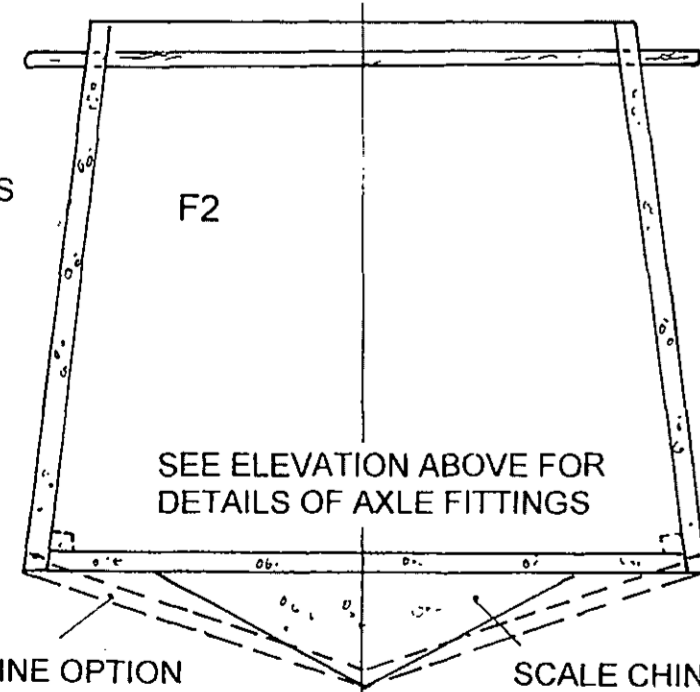

SEE ELEVATION ABOVE FOR DETAILS OF AXLE FITTINGS

HARD CHINE OPTION

SCALE CHINE

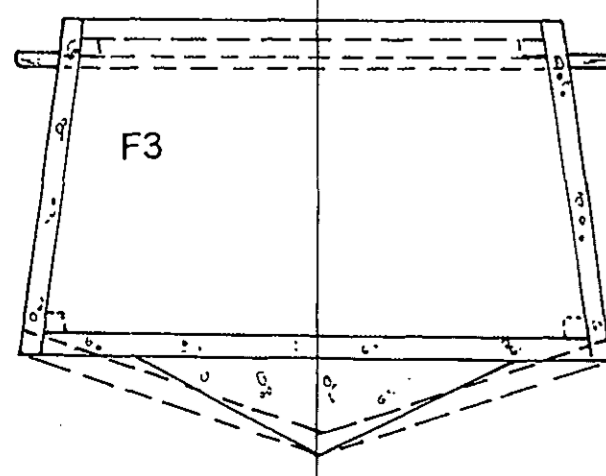

F3

FOAM NOSEBLOCK REBATE TO FIT BETWEEN SIDES

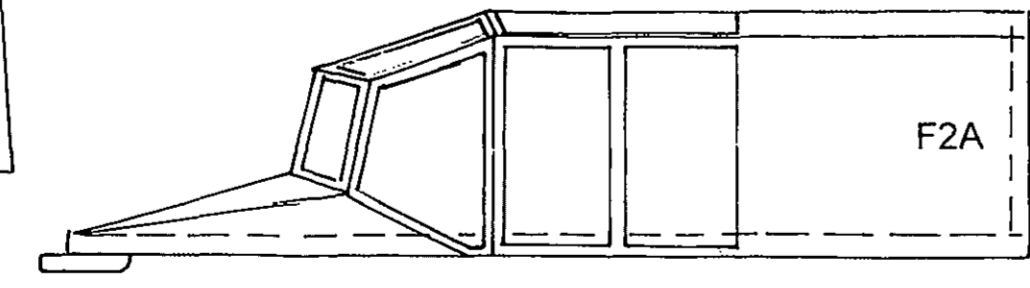

COCKPIT FORMS RADIO ACCESS HATCH

SCALE HULL CUT FROM FOAM AFTER MAIN FUSELAGE IS CONSTRUCTED

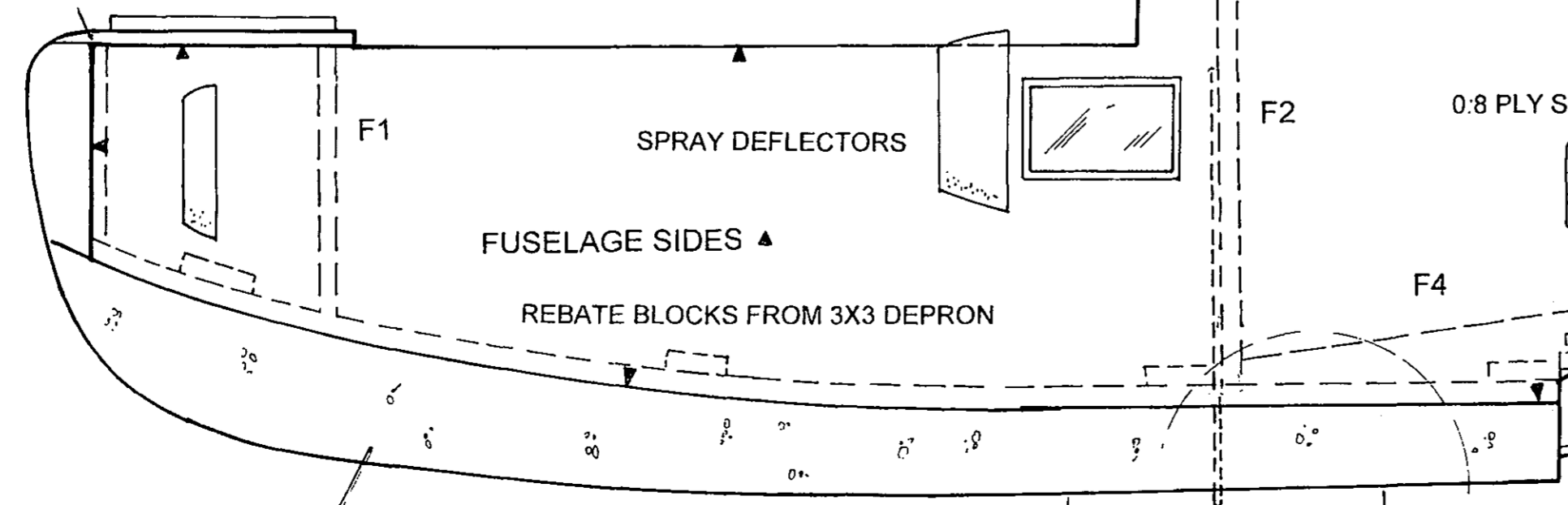

FUSELAGE SIDES

REBATE BLOCKS FROM 3X3 DEPRON

SPRAY DEFLECTORS

0.8 PLY SERVO PLATES

REAR CHINE FROM DEPRON - SEE SECTION AT F3

SCALE WHEEL LOCATION

SECTION AT FRONT STRUT

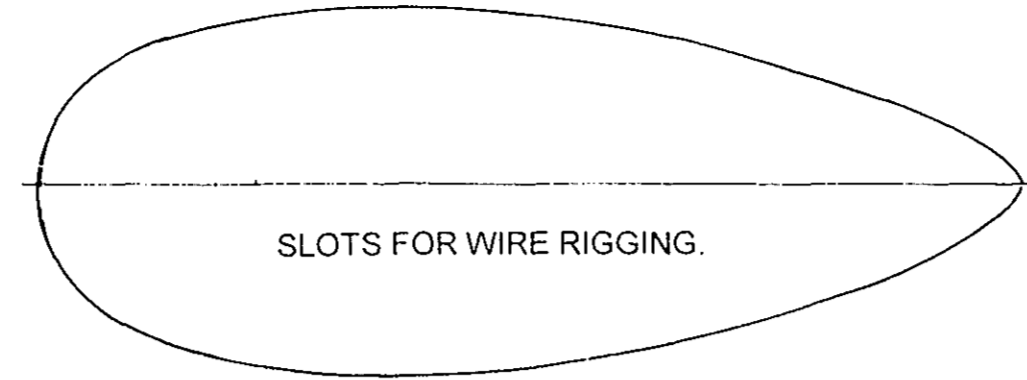

SLOTS FOR WIRE RIGGING.

SECTION AT REAR STRUT

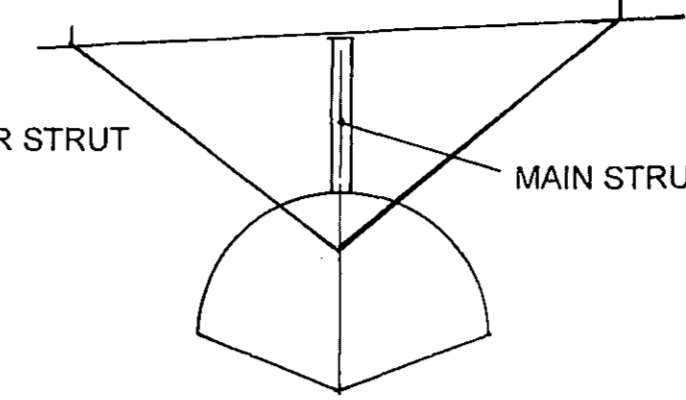

WIRE "/>

MAIN STRUTS ARE JUST DUMMIES

SUPERMARINE WALRUS (THE "SHAGBAT")

BY TREVOR HEWSON AND MIKE ROACH, FOR GWS S2 MOTOR AND DEPRON CONSTRUCTION

ALL MATERIALS 3.0mm DEPRON UNLESS STATED

NOTE THAT THE WHOLE ENGINE POD IS OFFSET TO GIVE 3 DEGREES RIGHT AND 2 DEGREES UP-THRUST

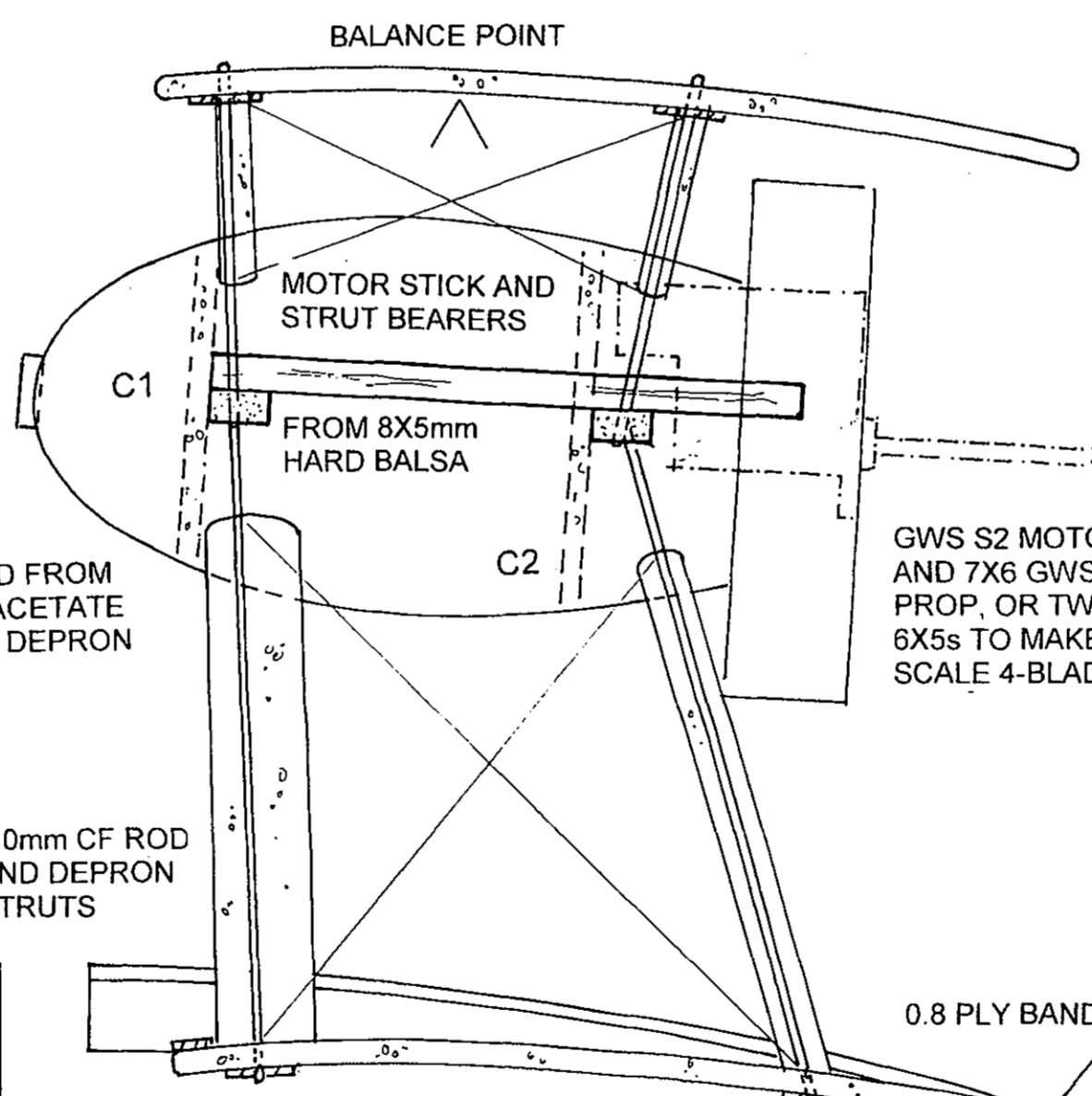

BALANCE POINT

MOTOR STICK AND STRUT BEARERS

FROM 8X5mm HARD BALS

ENGINE POD FROM MOULDED ACETATE OR FOAM & DEPRON

2.0mm CF ROD AND DEPRON STRUTS

BRISTOL PEGASUS 9-CYL RADIAL ENGINE

FOAM CYLINDERS WITH THREAD FINS

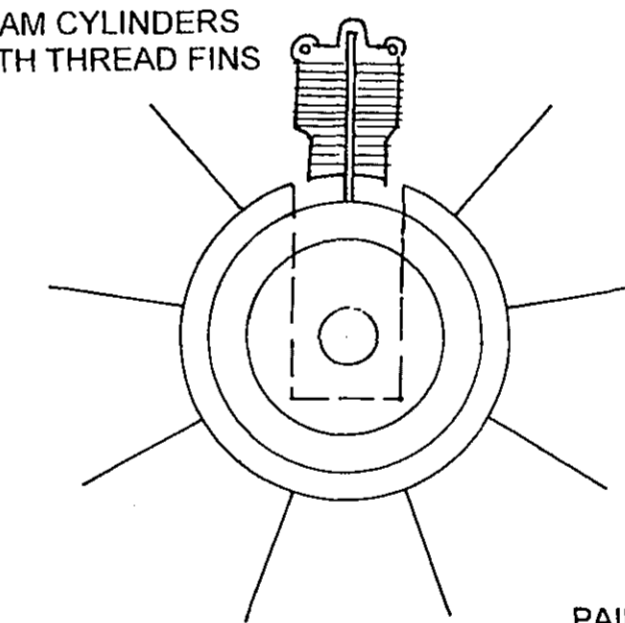

"CRANKCASE" FROM FOAM, CUT TO CLEAR GEARBOX

TOP CYLINDER GLUED SEPARATELY ONTO MOTOR HOUSING

WIRE OR CF ROD PUSHRODS

DEPRON DISCS CUT TO CLEAR PROP SHAFT

TAILPLANE HALVING SLOT NOTE INCIDENCE

USE LOW RATES ON RUDDER TO GIVE 20 DEGREES MOVEMENT EITHER WAY. ELEVATOR MOVEMENT 10 DEGREES EITHER WAY

EDGE HATCH WITH THIN CARD

CF ROD RUDDER PUSHROD WITH WIRE END FITTINGS

PUSHROD RUNS IN 1.5 BALS

GUIDES IN DEPRON SANDWICH

60 DEGREE BELLCRANK BUSHED WITH THIN PLY

SCRAP VIEW OF BELLCRANK ELEVATOR LINKAGE

ELEVATOR LINKAGE 22 SWG WIRE

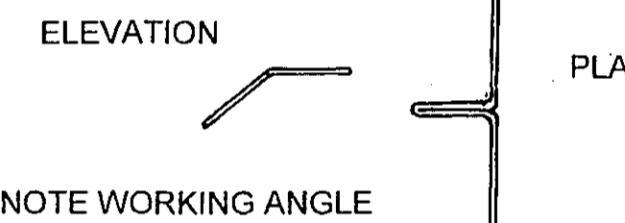

NOTE WORKING ANGLE

CUT-OUT TO CLEAR LINKAGE

HINGE WITH CUT DOWN COMMERCIAL HINGES OR TAPE

TAILWHEEL/WATER RUDDER

FROM 2 LAMS DEPRON ROUND PAPER-CLIP WIRE. EPOXY TO TAILPOST - OR MAKE STEERABLE?

SCALE DETAILS FROM THE HAMLIN CONCISE GUIDE TO BRITISH AIRCRAFT OF WWII. LOOK UP "SHAGBAT" OR "SUPERMARINE WALRUS" ON THE NET FOR FURTHER INFORMATION.

